

Welcome to Résidences Eole

Les Aliziers and Le Champbourguet at Super-Besse

Home page	p.1
Residence Les Aliziers	p.2 & p.3
Residence Le Champbourguet	p.4
Rates	p.5 & p.6
Rental Management	p.7
Activities	p.8



We are open and we waiting for you...

Respecting health regulations to make the most
of the resort and its surroundings...

**Studios and apartments for rent
in the heart of the resort**



If you have any queries or suggestions about our site, please don't hesitate to contact us.

We'll get back to you as soon as possible.

Contact us : residences.eole@gmail.com

LES ALIZIERS

Location

In the heart of the resort and 150 m from the gondola lift, this residence lets you make the most of your vacation, close to shops, the Lac des Hermines (100 m) and the "Les Hermines" leisure and sports center (150 m).

Lac Pavin, the youngest volcano in mainland France, is just a 5-minute drive away. You'll find it a soothing place, ideal for walks of varying lengths depending on your mood and conditions ;-)

The medieval town of Besse is just 7 km away. Here you can discover the local architecture on a stroll, and visit the market on Monday mornings.



Our rentals

When you choose the "Les Aliziers" residence, you'll have a choice of :

- 11 type A apartments, 36 m² (up to 6 people)
- 2 type B apartments, 40 m² (up to 6 people)
- 11 studios of 25 m² (4 people)

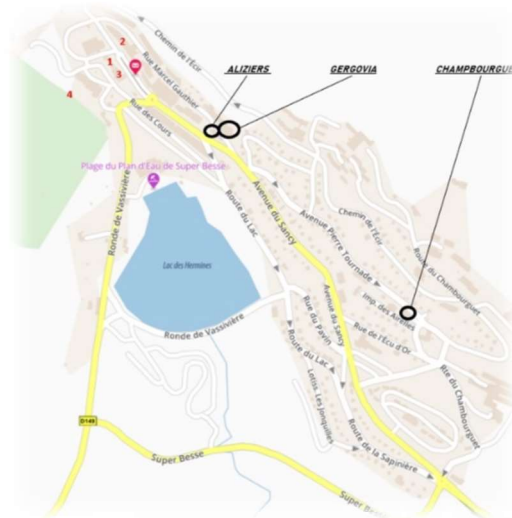

Apartment Type A

1 room and individual outside cupboard (practical for storing skis or suitcases, for example)

Living room with 2 sofa beds, 2 fold-away beds, TV and telephone

Kitchenette with 4 hotplates, oven, dishwasher, fridge, microwave, coffee-maker, toaster, kettle, raclette machine and crockery and cutlery.

2 bathrooms each with WC, bath and washbasin

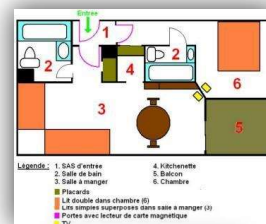

LES ALIZIERS

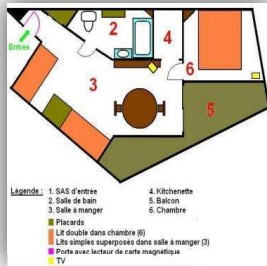

Type B apartment

The differences between the 2 apartment types are :

Type B, slightly larger (+4 m²)

1 single bathroom

Same equipment as apartment type A.

25 m² studio

1 room and individual outside cupboard (practical for storing skis or suitcases, for example)

Living room with 2 sofa beds, 2 fold-away beds, TV and telephone

Kitchenette with 4 hotplates, oven, dishwasher, fridge, microwave, coffeemaker, toaster, kettle, raclette machine and crockery.

1 bathroom with WC, bath and washbasin

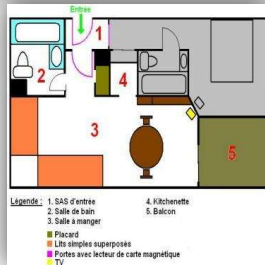

LE CHAMPROUGUET

Location

This sixteen-apartment residence has a captivating chalet-style exterior and interior design.

These large studio-cabins are located in the residential part of the resort, 800 meters from the heart of the resort, and are served by a free shuttle bus that stops next to the residence in winter.

Lac Pavin, the youngest volcano in mainland France, is just a 5-minute drive away. You'll find it a soothing place, ideal for walks of varying lengths depending on your wishes and conditions ;-)

The medieval town of Besse is just 7 km away. Here you can discover the local architecture on a stroll, and visit the market on Monday mornings.



Our Studios

Studio-cabin 33 m² with balcony or terrace depending on location

Ski closet

Living room with 1 double bed, 1 trunk bed with 1 pull-out bed, TV

Kitchenette with 4 hotplates, oven, fridge, microwave, coffee-maker, toaster, kettle, raclette machine and crockery.

1 bathroom with WC, shower and washbasin

RATES

Arrival from 4pm, Departure by 10am

School vacations: weekly stays only,

Outside school vacations: weekly stays (arrival day of your choice, subject to availability), mid-week and short stays on request.



S.A.R.L. ALIZIERS	Les Aliziers 33, avenue du Sancy 63610 Super Besse Studio 25 m² NC 4 pers. max.	Les Aliziers 33, avenue du Sancy 63610 Super Besse Appartement 40 ou 36 m² (Classified 3*) 6 pers. max.	Le Champbourguet 2, rue Pierre Tournadre 63610 Super Besse Studio-Cabin 33 m² (Classified 3*) 6 pers. max.
From saturday 08-07-23 to saturday 19-08-23	458€	564€	544€
From saturday 19-08-23 to saturday 02-09-23	320€	399€	366€
From saturday 02-09-23 to saturday 04-11-23	217€	299€	221€
From saturday 04-11-23 to saturday 23-12-23	198.90€* 221€	269.10€* 299€	198.90€* 221€
From saturday 23-12-23 to saturday 06-01-24	-	669€	554€
From saturday 06-01-24 to saturday 27-01-24	302.40€* 336€	393.30€* 437€	338.40€* 376€
From saturday 27-01-24 to saturday 10-02-24	382.50€* 425€	512.10€* 569€	401.40€* 446€
From saturday 10-02-24 to saturday 09-03-24	-	919€	799€
From saturday 09-03-24 to saturday 16-03-24	382.50€* 425€	512.10€* 569€	401.40€* 446€
From saturday 16-03-24 to saturday 30-03-24	302.40€* 336€	393.30€* 437€	338.40€* 376€
From saturday 30-03-24 to saturday 04-05-24	198.90€* 221€	269.10€* 299€	198.90€* 221€

The above rates include :

- rental charges included (water and electricity),
- supply of sheets and comforters for the stay.

They do not include :

- applicable tourist tax,
- final cleaning of the apartment,
- optional services (towel hire, indoor parking, etc.)

On arrival, you will be asked to pay a deposit of €200. This will not be cashed and will be returned on departure unless the apartment has been damaged.



Additional services :

- Linen and cleaning service
- Linen rental kit (1 small and 1 large towel, 1 bath mat): €4.50 per kit
- Bed made up on arrival: 10€ / double bed, 7€ / single bed
- Tea towel rental: €1.00 each
- Final cleaning service: €50 outside school vacations, €75 during school vacations
- Cleaning service during stay: €30 / service

Other :

- Free loan of baby chair, booster seat and cot

Terms and conditions of sale :

- 25% deposit on reservation,
- Balance payable on arrival.
- Payment methods accepted: bank checks, vacation checks, cash, credit card, bank transfer.

Modification and cancellation conditions :

- In case of shortening of the stay, the amount of the stay cannot be reduced.
- In the event of cancellation within 10 days of your arrival, the full balance of your invoice will be due.
- In the event of cancellation between the signing of the contract and the 11th day prior to your arrival, the deposit will be retained (cf. article L114-1 of the French Consumer Code).
- Please note: No cancellations will be accepted by telephone. To cancel your stay, you must send us a written notice (e-mail or letter). The date on which the document is sent will serve as the cancellation date.

Long-stay offer :

Not valid on end-of-year and February/March vacations

- -15% off the 2nd week
- -20% off the 3rd week

Cumulative with EarlyBooking offer

EarlyBooking offer :

Not valid on end-of-year, February/March and summer vacations, or on short stays.

Book at least 1 week before :

- 03/31 for the following summer season (after the Easter vacations to the end of the All Saints' Day vacations)
- 30/10 for the following winter season (after the All Saints' vacation to the end of the Easter vacation)

To book a stay in one of our residences, please contact us

by telephone on +334-73-79-82-30

by e-mail: residences.eole@gmail.com

RENTAL MANAGEMENT

NEW this year, we're offering our property management services.

We'll consider any request, from the simple handover/return of keys to the complete management of your schedule.

Residence LE BURON - n°1413

43, avenue du Sancy 63610 SUPER BESSE

Studio 22m² convertible into 2-room apartment with 1 bedroom 11m² non adjoining

- Ideally located with a southern exposure in the center of the Super Besse resort, this studio designed for 1 or 2 people will enable you to be as close as possible to the resort's shops and activities.
- An 11m² bedroom with a sofa bed and a bunk bed can be rented as an extra, allowing you to sleep up to 6 people.
- Weekly or short-stay (2 nights minimum).

PRICE RATE STUDIO 22m² :

- from Saturday 08-07-23 to Saturday 26-08-23 : 69€/night, 20% discount for stays of 7 days or more.
- from Saturday 26-08-23 to Saturday 09-09-23 : 49€/night, 20% discount for 7 days or more
- from Saturday 09-09-23 to Saturday 11-11-23 : 39€/night, 25% discount from 7 days

If you wish the 11m² extension (non-adjoining room), add 10% to the price.

➤ **Rates include :**

- rental of accommodation
- Water and electricity

➤ **Not included in rates :**

- Applicable tourist tax,
- Bed linen (rental possible, €10 kit)
- Towels (rental possible, €4.50 kit)
- Final cleaning of accommodation (service available from 50€ to 75€ depending on period)

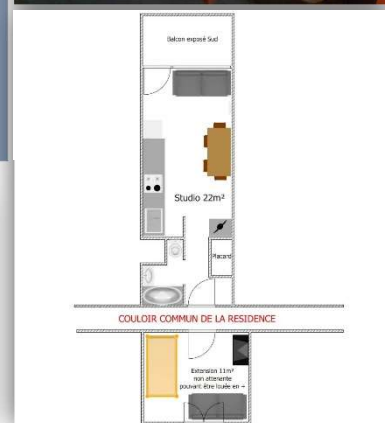

The resort :

Located in the heart of the Massif Central, Super-Besse is a family resort. In both summer and winter, a wide range of activities are available close to your rental accommodation.



Summer or winter, the family comes first!



In summer...

Come and discover the massif thanks to the many hiking trails that will take you to the Puy de Sancy, the Chaudefour valley and Lac Pavin.

The Lac des Hermines and its leisure center (pedal-boat, optimist, beach...) will enable you to relax by the water at the foot of the Puy de la Perdrix for a picnic or simply to fish (rainbow trout, perch, white fish).

« Super-Besse also has a downhill mountain biking area for beginners and experts alike. »

In winter...

- The 85 km of slopes at Super-Besse and Le Mont-Dore offer skiers and snowboarders (beginners and advanced) the chance to rediscover the pleasures of the slopes, with a snowpark and freestyle jump.
- At Super-Besse, an open-air ski area is available for less experienced skiers and snowboarders, with an introduction to carriage driving, dog sledding or simply a walk on the Massif du Sancy.
- Super-Besse is the perfect place to discover nature on snowshoes, with 22km of marked trails.



You can also discover the slopes in a different way during the nocturnes held every evening during the school vacations and on Sundays.

For the little ones, there's a tobogganing area and the ESF Piou-Piou club. Super-Besse is also a remarkable excursion center for discovering the Auvergne, with its wide-open spaces and colors that change with the seasons.



White in winter when the animals sleep under the snow and the trees are laden with frost. Multicolored in spring, when countless flowers adorn the slopes and marshes with their brilliant corollas.



Green in summer, when the herds have returned to the summer meadows and the bells are ringing.

Golden in autumn, when the beech trees rust and fall asleep, naked, for many months to come.